

39 368 000 TEMPERATURE SENSOR FOR URINAL

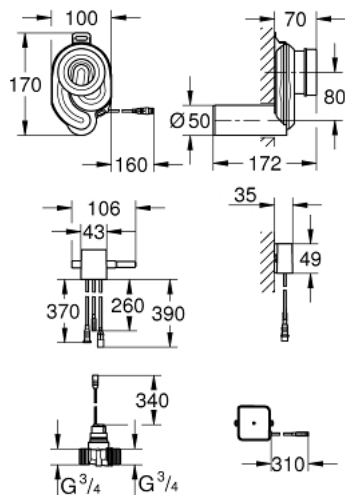

PRODUCT DESCRIPTION

- with transformer 100-240 V AC, 50-60 Hz, 6.75 V DC
- siphon with temperature sensor
- cartridge with solenoid valve and dirt strainer
- flow pressure min 0.5 bar
- operating pressure max 10 bar
- 7 pre-set programs:
 - auto flush
 - cleaning mode
 - pre-flush on/off
- CE approved



39 368 000 **TEMPERATURE SENSOR FOR URINAL**

SPARE PARTS, April 2015 – now

1: Solenoid valve (Spare part-nr. 42740000)

2: Waste trap (Spare part-nr. 42477000)

3: Electronic (Spare part-nr. 42478000)

4: Switching power supply (Spare part-nr. 42470000)

