

38 863 000 FLUSHING CISTERN FOR WC 80 MM

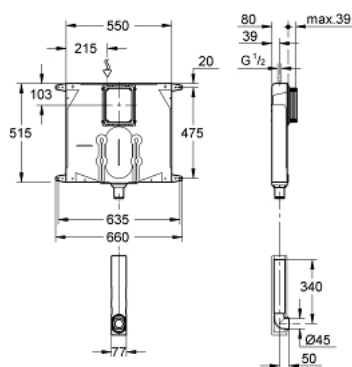

PRODUCT DESCRIPTION

- pneumatic discharge valve offering 3 modes of operation: dual flush or start/stop or single flush
- water supply connection from top
- low noise (group I acc. to German Noise Specification)
- with push fit flexible hose union
- angle valve 15 mm (½")
- Shortable inspection shaft incl. protection during construction phase, for vertical use
- fixing brackets
- without wall plate/actuation
- GROHE Water Saving - Less water, perfect flow
- for mounting of small flush plates revision shaft 40 949 000 to be ordered separately



38 863 000 FLUSHING CISTERN FOR WC 80 MM

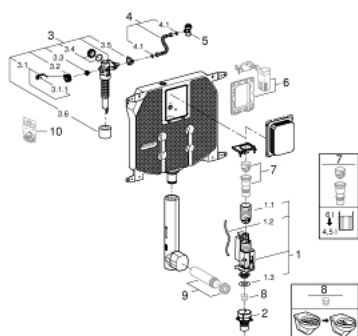

SPARE PARTS, May 2021 – now

1: Dual Flush discharge valve AV1 (Spare part-nr. 42320000)

1.1: Extension for overflow pipe (Spare part-nr. 42313000)

1.2: Pneumatic hose (Spare part-nr. 42319000)

1.3: Seal (Spare part-nr. 42310000)

2: Valve seat for GD2 (Spare part-nr. 42315000)

3: Filling valve (Spare part-nr. 43991000)

3.1: Valve Support (Spare part-nr. 43995000)

3.2: Lever (Spare part-nr. 43734000)

3.2.1: Seal (Spare part-nr. 4377000M)

3.3: Valve head (Spare part-nr. 43536000)

3.4: Membrane (Spare part-nr. 4375800M)

3.5: Screw cap (Spare part-nr. 43735000)

3.6: Valve FLOAT, 5 pcs.. (Spare part-nr. 4379100M)

4: Tube (Spare part-nr. 42233000)

4.1: Sealing washer (Spare part-nr. 0319100M)

5: Angle valve (Spare part-nr. 42343000)

6: Adaptor (Spare part-nr. 38796000)*

7: 4.5 l adapter for GD2 (Spare part-nr. 42333000)*

8: Flow restrictor

(Spare part-nr. 42300000)*

9: WC inlet and outlet connecting set (Spare part-nr. 37311K00)*

10: Set of seals (Spare part-nr. 43722000)*

* Optional accessories