

26 507 DC0 EUPHORIA SMARTCONTROL SYSTEM 310 DUO SHOWER SYSTEM WITH SAFETY MIXER FOR WALL MOUNTING

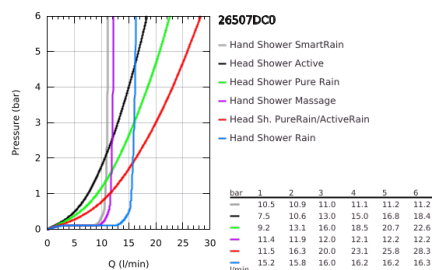
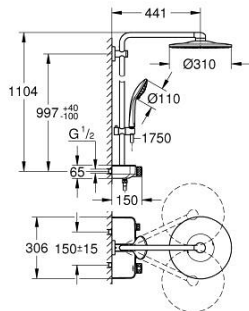

PRODUCT DESCRIPTION (1/2)

- Colour: supersteel
- horizontal 450 mm shower arm
- upper bracket adjustable for minimal adaption to existing drilling holes
- exposed SmartControl Safety Mixer
- allows change between:
- head shower Rainshower SmartActive 310

2 spray patterns:

- GROHE PureRain, ActiveRain
- maximum flow rate (at 3 bar): 20 l/min
- hand shower Euphoria 110 Massage, spray plate white

3 spray patterns:

- Rain, SmartRain, Massage
- maximum flow rate (at 3 bar): 16 l/min
- adjustable in height with gliding element
- Silverflex shower hose 1750 mm 1/2" x 1/2" (28 388)
- GROHE DreamSpray perfect spray pattern
- GROHE Long-Life finish
- GROHE CoolTouch no risk of scalding
- GROHE TurboStat compact cartridge

GROHE ProGrip with knurl structure

- GROHE SafeStop at 38°C

26 507 DC0 EUPHORIA SMARTCONTROL SYSTEM 310 DUO SHOWER SYSTEM WITH SAFETY MIXER FOR WALL MOUNTING

PRODUCT DESCRIPTION (2/2)

- GROHE SafeStop Plus optional temperature limiter at 43°C included
- GROHE SmartControl push for ON-OFF, turn for volume adjustment
- integrated GROHE EasyReach shower tray
- SpeedClean anti-lime system
- Inner WaterGuide for a longer life
- TwistStop to prevent hose from twisting
- suitable for instantaneous heaters from 18 kW/h
- minimum flow rate 7 l/min.

26 507 DC0 EUPHORIA SMARTCONTROL SYSTEM 310 DUO SHOWER SYSTEM WITH SAFETY MIXER FOR WALL MOUNTING

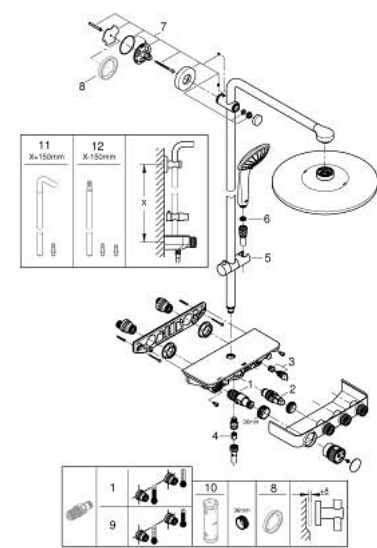

SPARE PARTS, July 2018 – November 2021

- 1: Thermostatic compact cartridge 1/2" (Spare part-nr. 47439000)
- 2: Cartridge (Spare part-nr. 48297000)
- 3: Non-return valve (Spare part-nr. 49069000)
- 4: Non-return valve (Spare part-nr. 08565000)
- 5: Glider (Spare part-nr. 48177DC0)
- 6: Dirt strainer (Spare part-nr. 0700200M)
- 7: Shower bar holder (Spare part-nr. 48279DC0)
- 9: GROHE TurboStat cartridge 1/2" (Spare part-nr. 47175000)*
- 10: Socket Spanner (Spare part-nr. 49059000)*

* Optional accessories