

25 229 AL0 ATRIO PRIVATE COLLECTION BATH MIXER 1/2"

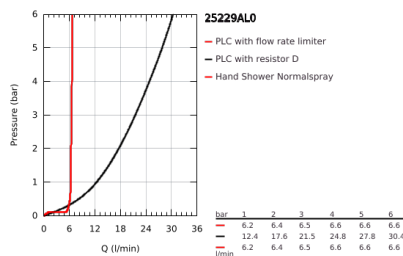

PRODUCT DESCRIPTION

- Colour: brushed hard graphite
- floor-mounted installation
- for use with rough-in set 45 984 001
- ceramic headparts 1/2", 90°
- GROHE LongLife finish
- automatic diverter: bath/shower
- projection 301 mm
- integrated non-return valve in shower outlet
- hand shower with holder
- Silverflex shower hose 1.250 mm (28 362)
- protected against backflow
- knobs with inlay, can be combined with 48 460 000 or 48 461 000
- without roughing-in set 45 984 (please order separately)

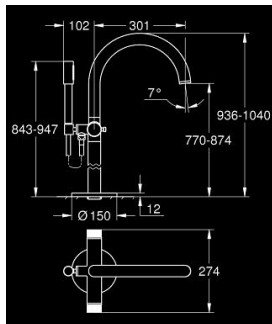

25 229 AL0 ATRIO PRIVATE COLLECTION BATH MIXER 1/2"

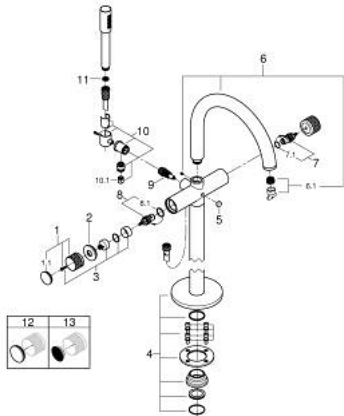

SPARE PARTS, May 2018 – now

- 1: Handle (Spare part-nr. 101342AL00)
 - 1.1: Cap (Spare part-nr. 101308AL00)
 - 2: Decorative ring (Spare part-nr. 101309AL00)
 - 3: Handle adaptor (Spare part-nr. 1012789990)
 - 4: Mounting set (Spare part-nr. 101341AL00)
 - 5: Diverter knob (Spare part-nr. 64989AL0)
 - 6: Outlet (Spare part-nr. 101320AL00)
 - 6.1: Mousseur (Spare part-nr. 13926000)
 - 7: Ceramic headpart, 1/2" (Spare part-nr. 45882000)
 - 7.1: O-ring Ø18,2 x Ø1,7 (Spare part-nr. 0392400M)
 - 8: Ceramic headpart, 1/2" (Spare part-nr. 45883000)
 - 8.1: O-ring Ø18,2 x Ø1,7 (Spare part-nr. 0392400M)
 - 9: Diverter (Spare part-nr. 48407AL0)
 - 10: Handshower holder (Spare part-nr. 101321AL00)
 - 10.1: Non-return valve (Spare part-nr. 08565000)
 - 11: Dirt strainer (Spare part-nr. 0700200M)
 - 12: Inlays made from White Attica Caesarstone material (Spare part-nr. 48460000)*
 - 13: Inlays made from Vanilla Noir Caesarstone material (Spare part-nr. 48461000)*
- * Optional accessories