

19 917 GN0 CONCEALED VALVE EXPOSED PART

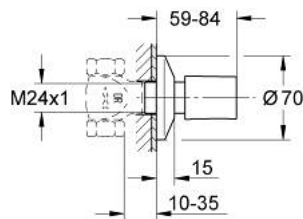

PRODUCT DESCRIPTION

- Colour: brushed cool sunrise
- for concealed valves 29 800 1/2", 29 802 3/4", 29 805 1"
- without concealed body
- adjustable installation depth 10 - 35 mm
- metal handle
- escutcheon



19 917 GN0 **CONCEALED VALVE EXPOSED PART**

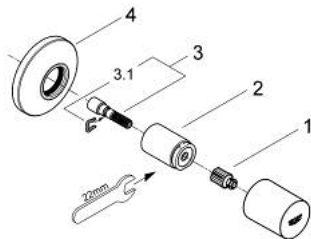

SPARE PARTS, July 2023 – now

- 1: Snap insert (Spare part-nr. 0538600M)
- 2: sleeve (Spare part-nr. 06688GN0)
- 3: Extension for spindle (Spare part-nr. 45201000)
- 3.1: Clip (Spare part-nr. 0256900M)
- 4: escutcheon (Spare part-nr. 06386GN0)