

## 19 917 A00 CONCEALED VALVE EXPOSED PART

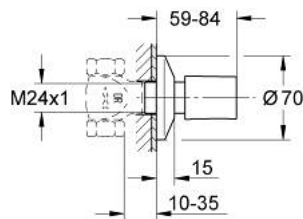

### PRODUCT DESCRIPTION

- Colour: hard graphite
- for concealed valves 29 800 1/2", 29 802 3/4", 29 805 1"
- without concealed body
- adjustable installation depth 10 - 35 mm
- metal handle
- escutcheon



## 19 917 A00 CONCEALED VALVE EXPOSED PART

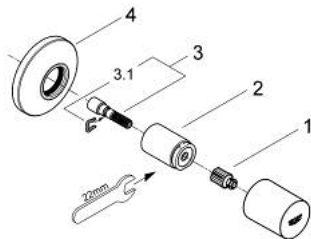

### SPARE PARTS, July 2023 – now

- 1: Snap insert (Spare part-nr. 0538600M)
- 2: sleeve (Spare part-nr. 06688A00)
- 3: Extension for spindle (Spare part-nr. 45201000)
- 3.1: Clip (Spare part-nr. 0256900M)
- 4: escutcheon (Spare part-nr. 06386A00)