

## 19 809 001 COSTA L CONCEALED VALVE EXPOSED PART

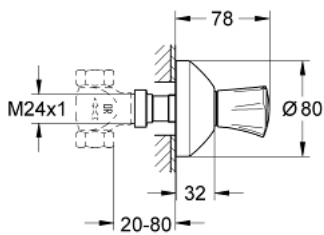

### PRODUCT DESCRIPTION

- Colour: chrome
- trim set for 35 028 000
- for concealed valves 29 800 1/2", 29 802 3/4", 29 805 1"
- installation depth infinitely adjustable 20-80 mm
- escutcheon with wall sealing
- screwable
- metal handle
- heat insulated
- marking: red
- GROHE LongLife finish



## 19 809 001 COSTA L CONCEALED VALVE EXPOSED PART

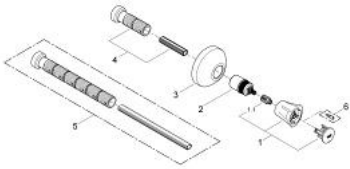

**SPARE PARTS**, February 2008 – now

- 1: Handle (Spare part-nr. 45994000)
- 1.1: Snap insert (Spare part-nr. 0538600M)
- 2: Extension for spindle (Spare part-nr. 45204000)
- 3: Escutcheon (Spare part-nr. 45219000)
- 4: Extension-set, 80 mm (Spare part-nr. 45202000)
- 5: Extension-set 200 mm (Spare part-nr. 45203000)\*
- 6: Screw for Costa/Avina products (Spare part-nr. 48013000)\*

\* Optional accessories